

Front Fog Lamp Bulb Replacement

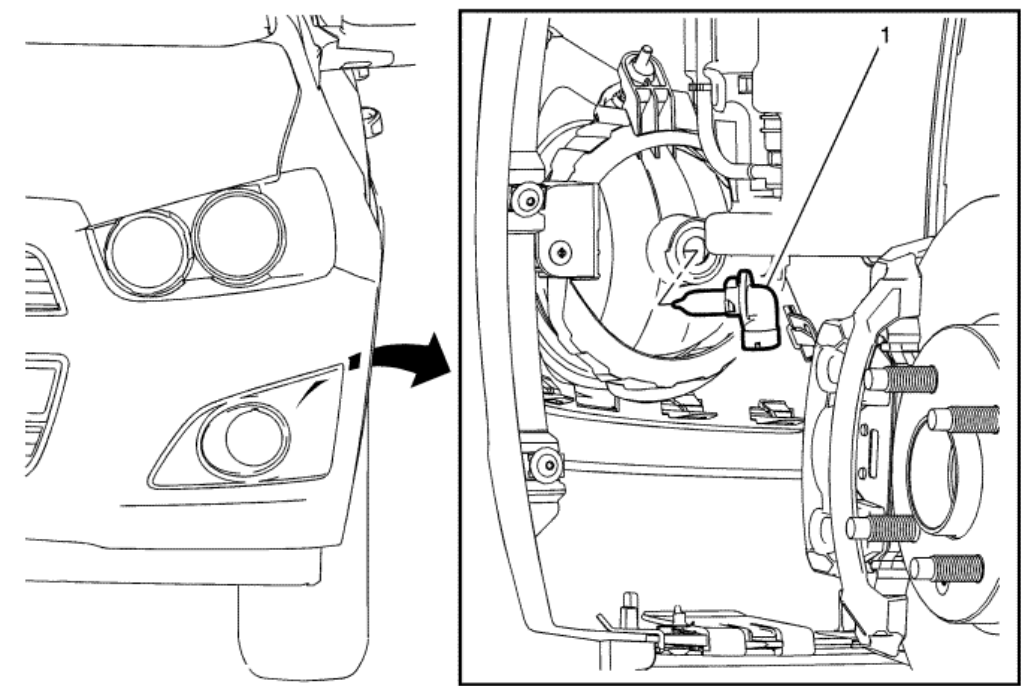

Callout	Component Name
<p>Preliminary Procedure</p> <p>1. Remove either the left front or right front wheelhouse liner. Refer to Front Wheelhouse Liner Replacement .</p> <p>2. Disconnect the electrical connector to the fog lamp bulb.</p>	
1	<p>Front Fog Light Bulb</p> <p>Warning: Refer to Halogen Bulb Warning in the Preface section.</p> <p>Turn the fog lamp bulb socket anticlockwise and remove from the fog lamp housing.</p>

